

The logo for the Institution of Civil Engineers (ICE), featuring the lowercase letters 'ice' in a white, sans-serif font on a dark teal background.

South East
England

The logo for Women in Property, consisting of a stylized 'W' shape formed by two overlapping triangles, one green and one blue.

**Women
in Property**
Aspire · Succeed · Inspire
womeninproperty.org.uk

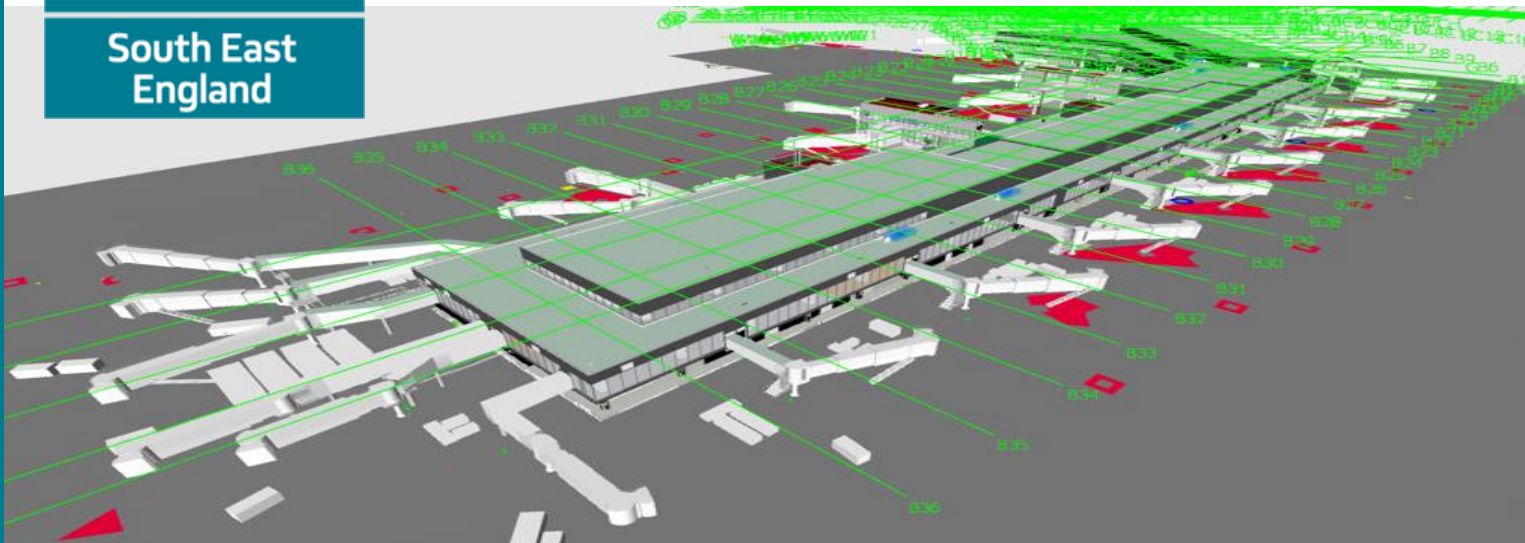

The Evolution of Design

ICE South Branch with Women in Property
Tuesday 25 June 2019 | 17.30 - 19.30

Winchester Guildhall | The Broadway | Winchester | SO23 9GH

To celebrate Women in Engineering, we are excited to be hosting a joint Women in Property and Institution of Civil Engineers event with Jenna Browning and Emily Duncombe from Arup presenting on the topic, 'how our approach to design has evolved and how design is changing with the digital era'.

Emily is the current Solent Women in Property Chair and a Chartered Civil Engineer with 11 years' experience designing building in the South Branch area. Jenna is a Chartered Civil Engineer with a diverse career in London, San Francisco and Winchester. She is on the digital steering group in Arup and is passionate about exploring new ways to improve the design process.

Please join us for networking and refreshments at 17.30. The talk will be followed by a Q&A discussion.

Space is limited so please pre-book here: <https://www.ice.org.uk/events/evolution-of-design-winchester>

In case of difficulties, contact anne.qualters@ice.org.uk

Institution of Civil Engineers is a Registered Charity in England & Wales (no 210252) and Scotland (SC038629)